

**69th  
Annual  
Conference & Meeting**



**Oregon Public  
Health Association**



**October 14 & 15, 2013  
Corvallis OR**

Greater Oregon Behavioral Health, Inc. (GOBHI) and its CCO partners are proud to sponsor the 2013 OPHA Annual Meeting & Conference



**GOBHI Headquarters**

309 East 2nd Street  
The Dalles, OR 97058  
Phone - (541) 298-2101  
Fax—(541) 298-7996

*Rural and frontier counties joined together to form GOBHI in 1995 when the Oregon Health Plan was launched. Recognizing that Rural counties could be stronger as a collective by sharing innovative programs and costs, rather than each county being at risk.*



# OPHA 69<sup>th</sup> Annual Meeting and Conference 2013 Agenda

**Monday, October 14, 2013**

- 8:00 – 9:00 Registration and Continental Breakfast** Gallery/Lobby-LaSells Stewart
- 9:00 – 9:30 Welcome and Opening Remarks** Austin Auditorium  
Tom Eversole, DVM, MS  
President – Oregon Public Health Association
- Tammy Bray, PhD  
Dean, College of Public Health and Human Sciences  
Oregon State University
- 9:30 – 10:30 Keynote Address: Connecting Health Care to Public and Environmental Health** Austin Auditorium
- Ted Schettler MD, MPH  
Science Director  
Science and Environmental Health Network
- Introduction: Jae Douglas, PhD, MSW  
Oregon Health Authority, Public Health Division
- 10:30 – 10:45 BREAK** Gallery/Lobby-LaSells Stewart
- 10:45 – 12:00 Concurrent Sessions #1**
- (A) PANEL: I-CAN Project (Interprofessional Care Access Network): Working Together towards Improving Health Outcomes for Underserved People in Oregon's Neighborhoods** Construction Engineering  
Moderator/Discussant: Peggy Wros  
*Nic Bookman, Katherine Bradley, Launa Rae Mathews*
- (B) PANEL: Developing Public Health Resilience Against Climate Affects** Alumni Ballroom AB  
Moderator/Discussant: Andrea Hamberg,  
*Brian Cooke, Kari Lyons-Eubanks*
- (C) HEALTH POLICY IMPACTS & IMPLEMENTATION** Agriculture Production  
Moderator/Discussant: Robb Hutson
- 1. What Do Oregon Legislative Staff Think About Public Health Issues?**  
*Craig Mosbaek*
- 2. Environmental Scans and Retailer Surveys: What, How and Local Policy impacts**  
*Jill Hutson, David Visiko, Kris Williams*

**3. Implementation of the Patient-Centered Primary Care Home (PCPCH) Model in Oregon: Experiencing Rapid Policy Change During Statewide Delivery Systems Transformation.**

*E. Dawn Creach, Paige Hatcher, Nicole Merrithew, Deepti Shinde, Evan Saulino*

**(D) USING HEALTH INFORMATION TECHNOLOGIES**

Alumni 111

Moderator/Discussant: Jan Wallinder

**1. The Truth is in the Frosted Mini-wheats: What Cereals Can Tell Us About Email, Smart Phone and App Usage by WIC Participants**

*Julie Reeder*

**2. Who uses the Internet to Identify Medical Conditions? An Analysis of National Data**

*Jennifer Faith, Sheryl Thorburn*

**3. Taking it to the Streets: Using the New Equity Atlas 2.0 and the HEAL Cities Campaign to Create Healthy Environments**

*Beth Kaye, Tamie Arnold, Scotty Ellis, Amanda Garcia Snell*

**(E) CAREGIVING RESEARCH & ALZHEIMERS AS A PUBLIC HEALTH ISSUE**

Agriculture Leaders

Moderator/Discussant: Kate Moore

**1. Alzheimer's Disease: An Emerging Public Health Concern**

*Charlie Fautin, Jon Bartholomew*

**2. Caregivers' Sense of Social Isolation and Life Disruption: A Qualitative Study**

*Elizabeth A. Gordan, Carolyn A. Mendez-Luck*

**3. Caregiving in Oregon - What Data from the BRFSS Tell Us**

*Elena Andresen, Eva Hawes, Willi Horner-Johnson*

**(F) HEALTH SYSTEMS CHANGE AND THE INTEGRATION OF SERVICES**

Agriculture Science

Moderator/Discussant: Anna Stiefvater

**1. One Key Question: Better integration of Preventive Reproductive Health into Primary Care**

*Helen Bellanca, Michele Stranger Hunter, Hannah Rosenau*

**2. Population-based Nursing; Strategies for Success**

*MaiKia Moua, Carrie Alexander, Anne Heenan*

**3. The Oregon Self-Management Hub: A Systems Approach for Sustainable Chronic Disease Self-management Resources**

*Danna Drum*

**(G) HEALTH BEHAVIOR CHANGE**  
Moderator/Discussant: Jennifer Morgan

Alumni 115

**1. Huge Demand for Diminishing Returns**  
*Stacey Schubert*

**2. Understanding Family Readiness for Behavior Change:  
Development of the Family Stage of Change Measure**  
*Patrick Abi-Nader, Deborah John, Katherine B. Gunter*

**3. What Stimulates Change? Translating Motivational Interviewing  
Theory into Practice**  
*Alissa Leavitt, Dana Sturtavant, Sara Gardner-Smith*

**12:00 – 1:15 Luncheon and Networking**

Alumni Ballroom C-Boxed Lunches

- |  |                            |
|--|----------------------------|
| (A) Chiropractic Section Meeting                   | Wells Fargo                |
| (B) Disabilities Section Meeting                   | Agriculture Production     |
| (C) Epidemiology and Biostatistics Section Meeting | Agriculture Leaders        |
| (D) Health Education & Promotion Section Meeting   | Construction & Engineering |
| (E) Nursing Section Meeting                        | Alumni Ballroom AB         |
| (F) Adolescent Health Section Meeting              | Agriculture Science        |
| (G) <i>Medical Providers for the Underserved</i>   | Alumni 111                 |
| (H) Healthy Environment                            | Alumni 115                 |

**1:15 - 2:30 Concurrent Sessions #2**

- |   |                            |
|---|----------------------------|
| <b>(A) PANEL: Nutrition Standards: A Tool for Creating Healthier Food Environments</b><br>Moderator/Discussant: Nancy Becker<br><i>Kim La Croix, Rebecca Pawlak, Amber Hansen</i>   | Alumni Ballroom AB         |
| <b>(B) PANEL: Oregon Public Health Nurse Home Visiting Programs: Medicaid Outcomes Evidence and Translation for Partnering with CCOs</b><br>Moderator/Discussant: Mary Ann Evans<br><i>Marilyn Sue Hartzell, Francine Goodrich, Lari Peterson</i> | Construction & Engineering |
| <b>(C) BENDING THE CURVE ON HEALTH EQUITY</b><br>Moderator/Discussant: Daniel Lopez-Cevallos  | Agriculture Production     |
- 1. Health Equity through Workforce Development and Online Learning**  
*Jennifer Moore*

**2. Using an Equity and Empowerment Lens for Quality Improvement in Public Health**

*Ben Duncan*

**3. Engaging Communities in Health Equity Policy Formation at the Oregon Health Authority, Office of Equity and Inclusion**

*Emily L. Wang, Tricia Tillman, Junghee Lee, Patricia Cortez*

**(D) INNOVATIONS IN SCHOOL NUTRITION**

Alumni 111

Moderator/Discussant: Nancy Findholt

**1. Availability of Healthy Snacks in Stores Near Low-Income Urban, High-Income Urban, and Rural Elementary/Middle Schools**

*Nancy E. Findholt, Betty Izumi, Hayley Pickus, Thuan Nguyen*

**2. Engaging Youth as Advocates to Create "Healthy Snacking Zones" around Rural Schools: First Year Results**

*Nancy E. Findholt, Betty Izumi, Jackilen Shannon, Thuan Nguyen, Carole Smith, Vicky Brogoitti*

**3. Farm to School: Looking Back at the 2013 Pilot Program, and Looking Toward the Future**

*Kassandra Griffin*

**(E) LATEST TRENDS IN BREASTFEEDING**

Agriculture Leaders

Moderator/Discussant: Alissa Leavitt

**1. An Expression of Love: Breastfeeding in Unique Foster Care Situations**

*Jeanette Howard, Anne Lenzi*

**2. Reliability of Mother-reported Age at Weaning: Evidence of Recall Bias using Data from the Oregon Pregnancy Risk Assessment Monitoring System (PRAMS) and PRAMS-2**

*Marit L. Bovbjerg, Adrienne E. Uphoff, Kenneth D. Rosenberg*

**3. The Role of Local Breastfeeding Coalitions in Advancing Public Health**

*Marion Rice*

**(F) RESEARCH METHODS AND COMMUNITY HEALTH**

Alumni 115

Moderator/Discussant: Brian K. Johnson

**1. Increasing Recruitment and Retention Rates Among Indigenous Farmworker Participants in a CBPR Project**

*Rebecca Allen, Julie Samples, Santiago Ventura, Valentin Sanchez, Stephanie Farquhar*

**2. Life Expectancy of Oregon American Indian and Alaska Natives Using Race Corrected Mortality Rates**

*Jenine Dankovchik, Megan Hoopes, Victoria Warren-Mears*



## THE OHSU EFFECT

Donn Spight, M.D., director of the OHSU VirtuOHSU Program, shares his knowledge with MedStars students who were visiting OHSU from around the state. MedStars, a collaboration between OHSU and Area Health Education Centers, encourages youths interested in careers in health and science to further their education in those fields.

### **Along with our community partners, OHSU health care providers, teachers and researchers:**

- Provide care to the underserved.
- Deliver education that extends the reach of health care.
- Engage in research that is vital to public and community health.
- Ensure access to the latest in medical advances.

OHSU relies on its associations with individuals and organizations around the region. The connections we share allow us all to achieve together what none of us could do alone.

**That's the OHSU Effect.**

[www.OHSUeffect.org](http://www.OHSUeffect.org)  
[www.ohsu.edu/community](http://www.ohsu.edu/community)



### **3. Using Focus Groups to Inform Advocacy and Program Planning**

*Robb Hutson*

#### **(G) TOBACCO CONTROL POLICY IN PRACTICE**

Agriculture Science

Moderator/Discussant: Paula Staight

##### **1. Evaluation of the First Year of Oregon State University's Smoke-free Campus Policy**

*Jessica A. Johnson, Lisa Hoogesteger, Marc Braverman*

##### **3. Evaluation of the First Year of University of Oregon's Smoke- and Tobacco- Free Campus Policy and Next Steps**

*Elliot Berkman, Paula R. Staight and Marci Torres*

##### **2. Use of Other Tobacco Products in Oregon and Implications for Tobacco Control Efforts**

*Steven Fiala*

**2:30 – 2:45 BREAK**

Gallery/Lobby-LaSells Stewart

**2:45 – 4:00 Concurrent Sessions #3**

#### **(A) PANEL: Health Impact Assessment's Ability to Highlight and Address Inequities: Stories from the Field**

Alumni Ballroom AB

Moderator/Discussant: Andrea Hamberg

*Tia Henderson, Kathleen Johnson, Megan Patton-Lopez, Annette Klinefelter*

#### **(B) PANEL: Pilot Project- Accreditation Mock Review Collaboration Between Marion & Clackamas County Health Departments**

Construction & Engineering

Moderator/Discussant: Erin Mowlds

*Lyndsie Schwarz, Pam Hutchinson, Philip Mason, Dana Lord*

#### **(C) INNOVATIONS IN MENTAL HEALTH**

Agriculture Production

Moderator/Discussant: Kelly Volkmann

##### **1. Peer Specialists: Who They Are, What They Do, and Why You Need Them!**

*Kelly Volkmann*

##### **2. Will an Incentive Work?: Mental Health Care Access in Low-income Pregnant Women at Risk for Perinatal Depression**

*Rebecca Sacks, Jessica Greene*

##### **3. Not Just a Job - The Role of Work in Wellness and Recovery**

*Rachel Solotaroff, Marisha L. Johnson, Catherine J. Coleman, Jeff Krolick*



**(D) EMPOWERING COMMUNITIES & WORKPLACES TO PROMOTE HEALTH**

Agriculture Science

Moderator/Discussant: Deborah John

**1. Crook County on the Move**

*Kris Williams, Muriel DeLaVergne-Brown, Carly Rachocki*

**2. Beginning a Dialogue: Healthy Eating, Active Living in Rural Yamhill County**

*Meghan Haggard*

**3. Wellness@WIC**

*Adrienne Paige Mullock*

**(E) DENTAL HEALTH INEQUITIES & FLUORIDATION POLICY**

Alumni 115

Moderator/Discussant: Ken Rosenberg

**1. Inequities in the Managed Care Medicaid Dental Delivery System in Oregon**

*Eli Schwarz, Alynn Vienot*

**2. Lessons learned from Portland's May 2013 Fluoridation Campaign**

*Kurt Ferré*

**3. Social and Political Correlates of Oregon Fluoridation Opposition**

*Charles C. Haynie, Kurt Ferré*

**(F) OCCUPATIONAL HEALTH & SAFETY**

Alumni 111

Moderator/Discussant: Laurel Kincl

**1. Elevated Occupational Transportation Fatalities Among Older Workers in Oregon; An Empirical Investigation**

*Jamie Jones, Daniel Cain, Ryan Olson, Jaime Walters, Erika Zoller, Jae Douglas, Justin Karr*

**2. Occupational Safety and Health Meets Worksite Wellness and Wellbeing**

*Dede Montgomery*

**3. An Integrated Approach for Individuals with Disabilities: Workplace Safety, Health and Wellness**

*David Grim, Mara Nery, Simon Driver, Laurel Kincl*

**(G) YOUTH AND CHILD NUTRITION AND PHYSICAL ACTIVITY**

Agriculture Leaders

Moderator/Discussant: Marit Bovbjerg

**1. Associations Between the Family Nutrition and Physical Activity Environment and Successful Learning Characteristics in Corvallis Elementary School Children**

*Jenny Jackson, Katherine B. Gunter, Deborah John*

## 2. Physical Activity and Obesity in Children with Autism

*Kiley Tyler, Nicole Cook, Katherine Anthony, Megan MacDonald*

## 3. Creciendo en Salud: Systems Change to Support Physical Activity Among Latino Youth in a Rural Community Through Grass Roots and Inter-governmental Collaboration

*Mégan Patton-López, Rocío Muñoz*

### OPHA Board of Directors Meeting

Wells Fargo

### 4:00 – 6:00 POSTER SESSION & NETWORKING

Hors d'oeuvres

Alumni Lobby

### 5:30 – 7:00 Public Health Book Group

Raising Elijah: Protecting Children in an Age of Environmental Crisis

by Sandra Steingraber

Hilton Garden Inn Lobby

Discussant: *Sara Gardner-Smith*

*Hosted by the OPHA Health Education & Promotion Section*

## End of Day One

the *Spirit of Healing* is  
Profound Empathy



**Sudeshna Banerjee, MD**  
PeaceHealth Sacred Heart Medical Center  
at RiverBend, Springfield, OR



**P**rofound  
empathy.  
Unwavering  
compassion.

Dedication. That's how our friends and colleagues describe our promise at PeaceHealth. We call it The Spirit of Healing.

The Spirit of Healing means we treat you like family. Like a person, not a patient. We hold your hand through fear and joy. We are committed to caring for you because this is our place. Our community. Our mission.

The Spirit of Healing is our promise to you. Because we believe in healing the mind, body and spirit. Every time. Every touch.

Hear stories of our healing spirit at [PeaceHealth.org](http://PeaceHealth.org)



**PeaceHealth**

The *spirit* of healing®



**OREGON  
M P H**

MASTER OF PUBLIC HEALTH

[www.oregonmph.org](http://www.oregonmph.org)

503-725-5186



There's a planet that needs you - join the world of public health.



# OPHA 69<sup>th</sup> Annual Meeting and Conference 2013 Agenda

**Tuesday, October 15, 2013**

- 8:00 – 8:30 Registration & Continental Breakfast** Gallery/Lobby-LaSells Stewart
- 8:30 – 9:00 Welcome and Introductory Comments** Austin Auditorium  
Brian K. Johnson, MPH  
President-Elect – Oregon Public Health Association
- 9:00 – 9:30 Brief Reports from OPHA Sections** Austin Auditorium  
Introductions: Brian Johnson
- 9:30 – 10:30 Keynote Address: Rebuilding America's Middle Class:  
The Role that Public Health Plays** Austin Auditorium  
US Senator Jeff Merkley  
  
Introduction: Nicole Maher, MPH  
Northwest Health Foundation
- 10:30 - 10:45 BREAK** Gallery/Lobby-LaSells Stewart
- 10:45 – 12:00 Concurrent Sessions #4**
- (A) PANEL: Healthy Columbia Willamette:  
Assessing Community Needs, Improving Health** Alumni Ballroom  
Moderator/Discussant: Rachel Burdon  
*Priscilla Lewis, Sunny Lee, Kathleen O'Leary*
- (B) PANEL: Early Learning, Coordinated Care and Local  
Health Departments: Working Together Locally for  
Improved Health** Construction & Engineering  
Moderator/Discussant: Lila Wickham  
*Diane Kilkenney, Maggie Machala, Teri Thalhofer*
- (C) BUILDING COMMUNITY CAPACITY** Agriculture Production  
Moderator/Discussant: Nancy Findholt
- 1. High Risk Drinking Prevention in Benton County: How to  
Effectively Mobilize, Build Capacity, and Engage Communities**  
*Kelly Locey, Alicia Griggs, Julee Christianson*
- 2. Impacting the Community: The Jackson County Latina Health  
Coalition**  
*Nancy Castillo, Joanne Noone, Maggie Sullivan, Belle Shepherd,  
Teresa Esqueda, Tiffany L. Allen*

### **3. Using HEAL MAPPS to Build Community Capacity Among Latinos**

*Tina Dodge Vera, Deborah John*

## **(D) COLLABORATIVE APPROACHES TO IMPROVING MATERNAL & INFANT HEALTH**

Alumni 115

Moderator/Discussant: Katherine Bradley

### **1. Impact of Outreach Educational Video on Pulse Oximetry Screening in Newborns to Detect Critical Congenital Heart Disease**

*Heather Siefkes, Whitnee Hogan, Shannon Flood, Katrina Ramsey, Mark Reller, Amy Starmer, Carrie Phillipi*

### **2. Improving Maternity Care for Low Income Women with Diabetes: A Multidisciplinary Approach**

*Lisa Chickadonz, Maria Leiva*

### **3. Out-of-Hospital Births in Oregon**

*Anna Stiefvater, Sarah Hargand, Genevieve Buser*

## **(E) STRATEGIES TO PROMOTE YOUTH SEXUAL HEALTH**

Agriculture Leaders

Moderator/Discussant: Jocelyn Warren

### **1. Replicating Evidence-Based Sexual Health Programs Among At-Risk Youth**

*Mercy W. Mwaria, Nanci Coppola, Eric Witmer*

### **2. Urban African American Adolescents' Romantic Relationships: Positive Implications for STI/HIV Prevention**

*Senna Lee Towner, M. Margaret Dolcini, Joseph Catania, Gary W. Harper*

### **3. Effectively Engaging Teen Populations in Refining and Improving Sexual Health Services**

*Kelly Locey, Alicia Griggs, Andy Chuinard, Patrick Abi Nader*

## **(F) OREGON FARMWORKERS HEALTH RISKS**

Alumni 111

Moderator/Discussant: Katie Conte

### **1. Pilot Study to Assess Risk Factors for Heat-Related Illness Among Oregon Farmworkers**

*Jeffrey Bethel, Renee Harger*

### **2. Potential for Multiple Pesticide Exposures Among Blueberry and Cherry Workers Performing Reentry Tasks**

*Kathy Blaustein, Paul C. Jepson*

### **3. Working Conditions and Fluid Consumption Among Oregon Farmworkers**

*Renee Harger, Jeffrey Bethel*

**(G) APPLICATIONS IN EPIDEMIOLOGY & BIostatISTICS**

Agriculture Science

Moderator/Discussant: Torrie Fields

**1. Applications of Functional Data Analysis: Real-Time Monitoring Data in Public Health**

*Andres Houseman, Megan MacDonald, Megan McClelland*

**2. Expansion of Oregon Tracking's Dynamic Data Portal**

*Tara Chetock, Eric Main*

**3. What's Hot/ What's Not: Overview of the Health Status of Oregonians**

*Katrina Hedberg*

**12:00 – 1:30 OPHA Business Meeting and Awards Luncheon**

Alumni Ballroom

**1:30 – 1:45 BREAK**

Gallery/Lobby-LaSells Stewart

**1:45 – 3:00 Concurrent Sessions #5**

**(A) PANEL: Smokefree Cars for Kids: Clearing the Air for Healthier Kids**

Alumni Ballroom

Moderator/Discussant: Colleen Hermann-Franzen

*State Senator Elizabeth Steiner Hayward, Christel Allen*

**(B) PANEL: A Collaborative Journey Along the Road to a Culture of Quality: A Regional Effort**

Construction & Engineering

Moderator/Discussant: Kristin Tehrani

*Cally Kamiya, Marisa McLaughlin, Philip Mason, Jennifer Lund*

**(C) INJURY PREVENTION & EMERGENCY PREPAREDNESS**

Alumni 111

Moderator/Discussant: Jeff Bethel

**1. Oregon Alliance to Prevent Gun Violence: Coalition Building and Advocacy**

*Kylie Menagh-Johnson*

**2. Posttraumatic Stress Disorder and Risk of Motor Vehicle Crash Hospitalization among Recent Veterans Enrolled in Veterans Health Administration**

*Aisling Fernandez, Kathleen F. Carlson, William Lambert, Dawn Peters, Maya E. O'Neil, Jonathan Duckart*

**3. The Plan and Practice for an Emergency**

*Sara Fillion, Carolyn Stegall*

**(D) DISPARITIES IN RACE, ETHNICITY AND REFUGEE HEALTH**

Alumni 115

Moderator/Discussant: Chunhuei Chi

**1. Hepatitis B Screening and Linkage to Care, Multnomah County Communicable Disease Services, 2012-2013**

*Jaime Walters, Kamar Haji-Mohamed*



## A HEALTHY COMMUNITY IS OUR BUSINESS.

At Kaiser Permanente, our commitment to total health extends into the communities we serve — improving access to care, promoting healthy eating and active living, and sharing our research and knowledge.

To learn more about our involvement in the community, please visit: [kp.org/communitybenefit/nw](http://kp.org/communitybenefit/nw).



©2013 Kaiser Foundation Health Plan of the Northwest



SCHOOL OF PUBLIC HEALTH  
UNIVERSITY of WASHINGTON



## Executive MPH

*A Flexible, World-Class Program*

Designed for professionals who take on today's major health challenges. Learn from expert faculty and a diverse community of professionals. **Contact us to apply.**

[www.uwemph.org](http://www.uwemph.org) | 206-685-7580 | [uwemph@uw.edu](mailto:uwemph@uw.edu)



## Inform. Educate. Connect.

Go online to [salemhealth.org/chec](http://salemhealth.org/chec) or call 503-814-2432 for more information



CHC-137

Your partner in **INNOVATIVE BEHAVIORAL RESEARCH** to **IMPROVE HEALTH ACROSS THE LIFESPAN**



**Oregon Research Institute**

*Advancing science. Enhancing lives.*

[www.ori.org](http://www.ori.org)

**2. Racial/Ethnic and Insurance Status Disparities in Post-Hospitalization Care for Patients with Traumatic Brain Injury**  
*Wendy G. Kane, Dagan A. Wright, Rongwei Fu, Kathleen F. Carlson*

**3. Health Needs of African Refugees and Immigrants**  
*Seth Asare, Ahmed Iya, Isabelle Soule*

**(E) CROSS-SECTOR COLLABORATIONS**

Agriculture Production

Moderator/Discussant: Kate Moore

**1. Chronically Absent Students: An Opportunity to Expand Public Health Partnerships with Educators**

*Tia Henderson, Andrew Dyke*

**2. Climate Smart Communities Scenarios Health Impact Assessment**

*Andrea Hamberg*

**3. "See Well to Learn Well" - The Lincoln School Vision Project**

*Monica Juarez, Fabiola Herrera*

**(F) ACHIEVING EQUITY IN FOOD ACCESS & NUTRITION**

Agriculture Science

Moderator/Discussant: Robb Hutson

**1. Subsidizing local produce for 90,000 Oregonians: WIC Farm Direct in 2012**

*Rebecca Seel, Laura Wendel*

**2. Everything is Everything: Spatial Association Between Areas of High Poverty and High Obesity Rates with Implications for Public Health, Nutrition, and Anti-poverty Policies**

*Suzanne Porter, Laurel Goode*

**3. Improving Health Equity Through Community Food Systems**

*Mégan Patton-López, Megan Newell-Ching, Doris Cancel-Tirado, Kristty Polanco*

**(G) Discussion of Various Definitions of Population Health and the Implications they have for Public Health and CCO/ACO Relationships**

Agriculture Leaders

*Lillian Shirley*

**3:00 – 3:15 BREAK**

Gallery/Lobby-LaSells Stewart

**3:15 – 4:30 Concurrent Sessions #6**

**(A) PANEL: ObamaCare and Coordinated Care Organizations: Does Oregon Need Any More Health Care Reform?**

Alumni 115

Moderator/Discussant: Kenneth D. Rosenberg

*Peter N. Mahr, Michael Huntington, Sumeeth Bhat*

- (B) **PANEL: Preventing Obesity Among Rural Children: Changing the Context is Key** Construction & Engineering  
Moderator/Discussant: Katherine B. Gunter  
*Katherine B. Gunter, Deborah H. John, Jenny Jackson*
- (C) **ISSUES IN COMMUNITY HEALTH IMPROVEMENT** Agriculture Leaders  
Moderator/Discussant: Katherine Bradley
- 1. Community Health Workers in Rural Primary Care: Implementation Issues**  
*Cherry Pisigan, Deborah Messecar, Katherine J Bradley*
  - 2. Crowdfunding and Community Health Projects: A Quick Intro for Public Health Professionals**  
*Hope Leman*
  - 3. Oregon's Manufactured Housing Stock: Implications for Resident Health**  
*Annette Klinefelter, Andree Tremoulet*
- (D) **LATINO SEXUAL & REPRODUCTIVE HEALTH** Agriculture Production  
Moderator/Discussant: Deanne Hudson
- 1. A Family to Plan: The Interaction of Fatherhood Status and Partners in the Sexual and Reproductive Health of Mexican Immigrant Men**  
*Doris I. Cancel-Tirado, Marie Harvey*
  - 2. Development of a Theater Intervention to Promote Latino Parent-Adolescent Sexual Communication**  
*Joanne Noone, Nancy Castillo, Tiffany L. Allen, Teresa Esqueda*
  - 3. Let's Talk About P-Y-D: How Positive Youth Development Influences Sexual Health Outcomes in Latino Youth**  
*LaShanda N. Eller, Lindsay Weaver, Jessica E. A. Duke*
- (E) **PERCEPTIONS AND CHALLENGES IN VACCINATIONS AND SCREENINGS** Agriculture Science  
Moderator/Discussant: Torrie Fields
- 1. Exploring Perceptions and Choices of Nursing Students Regarding Influenza Vaccination**  
*Kristen Wils*
  - 2. Vaccine Beliefs of Complementary and Alternative Medical (CAM) Providers in Oregon**  
*Sandra J. Bean, Joseph A. Catania*



**(F) ISSUES IN ENVIRONMENTAL PUBLIC HEALTH**

Alumni 111

Moderator/Discussant: Curtis Cude

**1. Anhydrous Ammonia Releases in Columbia County: A Success Story**

*Kacey Setzer, Yuliya Goldman*

**2. Concentrated Animal Feeding Operations and Environmental Estrogens**

*Jeremiah Nelson*

**3. Protecting Public Health in Oregon via Fish Consumption Advisories**

*David Farrer*

*Conference Conclusion*

FamilyCare

HEALTH PLANS



Protect your loved ones -  
get a flu shot!



Connect to us!

 /FamilyCareOre

 /FamilyCareOre

[familycarehealthplans.org](http://familycarehealthplans.org)

*Proud to contribute  
to a healthier community*



Samaritan Health Services proudly provides community-based primary and specialty health care services, focusing on individualized care that embodies all aspects of health and wellness as part of its commitment to build healthier communities together.



## Join the Conversation

*OPHA is the voice of public health in Oregon*

Be a part of that voice by participating in our active social media



Conference Hashtag #OPHA2013

Coming to [#OPHA13](#) and want to learn [Twitter?](#)

We can show you--check out the LaSells Stewart Lobby for the Tweet Lab  
The most conference-related tweets wins an I-Pad Mini!

OPHA 2013 Wi-Fi    User: 12Oct26    Password: paleHyena  
Log onto: Guest Conference and Select: Local Data Base (not ONID)

To OSU Campus and Parking Garage

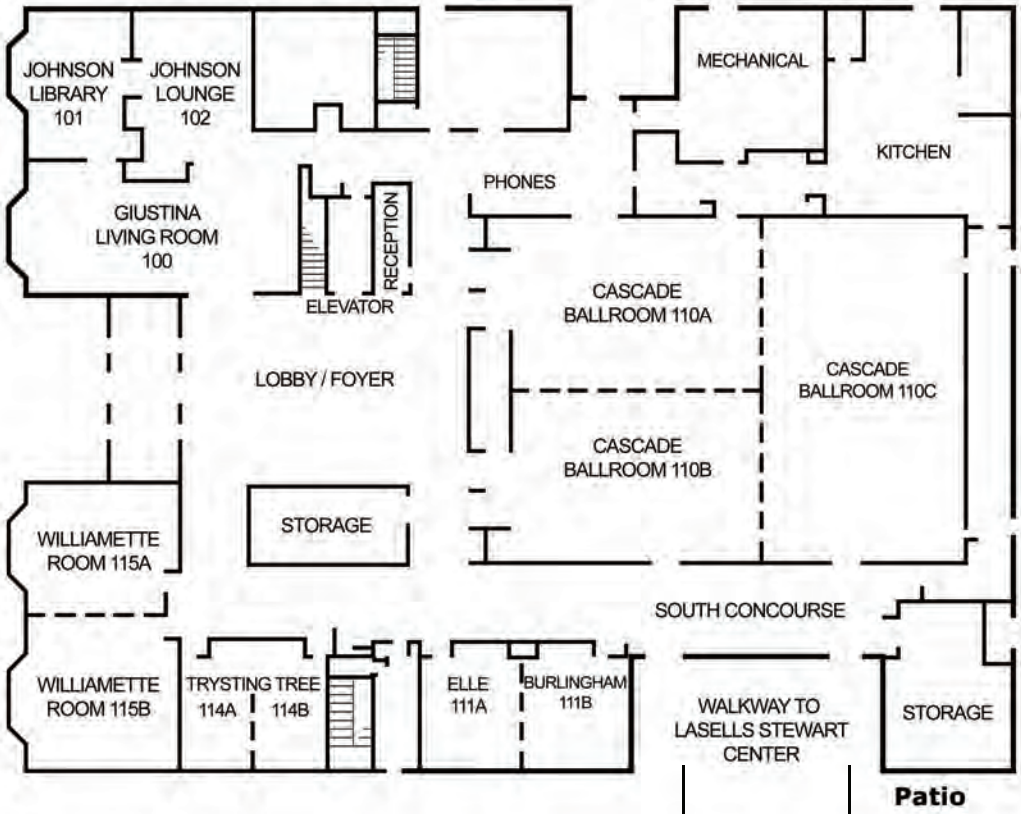

# CH2M HILL Alumni Center

26th Street and Reser Stadium Parking Lot

Lawn  
Covered Walkway

# LaSells Stewart Center

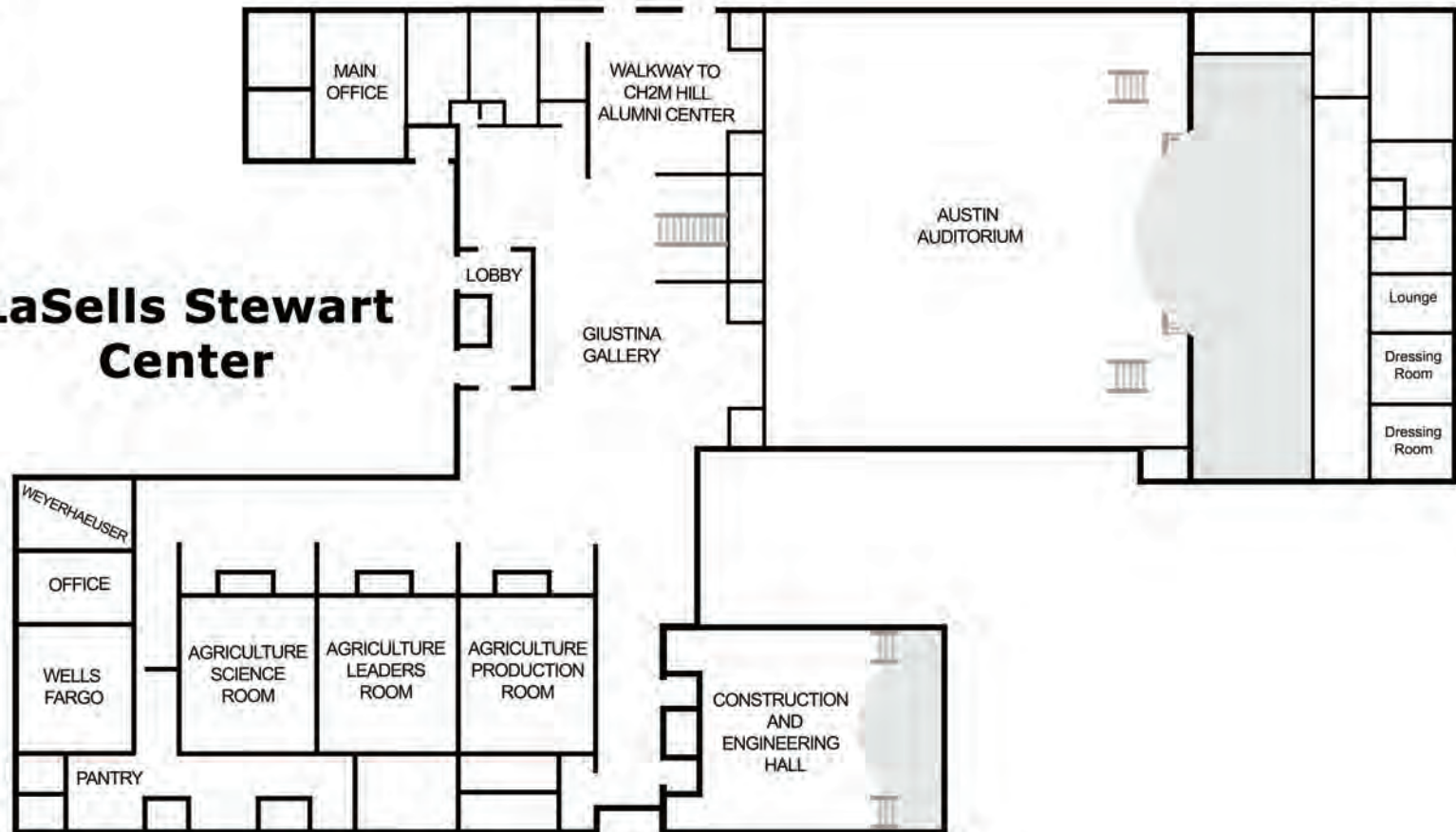

To Hilton Garden Inn and Highway 34

# Notes

OPHA 2013 is made possible by the generous support of:

**Diamond  
Sponsor**



**Gold  
Sponsors**



**Silver  
Sponsor**



**Day 2  
Keynote  
Sponsor**

**NORTHWEST HEALTH  
FOUNDATION**

*The Community's Partner for Better Health*

**Bronze  
Sponsors**



**Community  
Partners**



**Exhibitors**

Multnomah County Health Department Community Health Services  
OHA Recruitment  
OHSU CROET  
OHSU Library  
Oregon Public Health Institute  
Vault by BendBroadband

COLLEGE OF PUBLIC HEALTH AND HUMAN SCIENCES

# Graduate public health programs at Oregon State

## Join us!

Through rigorous academic programs and a diverse range of research endeavors, graduate students gain the theoretical foundations, applied research techniques and professional skills to function effectively in reducing risks, promoting health and preventing premature disease and disability in human populations.

Choose from a comprehensive range of MPH degree options in six major tracks

- Biostatistics
- Environmental and Occupational Health and Safety
- Epidemiology
- Health Management and Policy
- Health Promotion and Health Behavior
- International Health

In addition to offering the MPH, we are the only institution in Oregon that offers a Ph.D. in public health.

The degree is offered with concentrations in

- Environmental and Occupational Health and Safety
- Health Policy
- Health Promotion and Health Behavior

Learn more by contacting [eileen.kaspar@oregonstate.edu](mailto:eileen.kaspar@oregonstate.edu) or visiting [bit.ly/osu-public-health](http://bit.ly/osu-public-health).

Oregon State's Ecampus offers an online graduate certificate in public health. Credits earned from the six courses in this program may be applied toward an MPH. Find out more at [ecampus.oregonstate.edu/health](http://ecampus.oregonstate.edu/health).

*Ensuring lifelong health and well-being for every person, every family, every community*

**Oregon State**  
UNIVERSITY

“IF SOMETHING CATASTROPHIC HAPPENS, I DON’T WANT TO WONDER IF I’M GOING TO LOSE MY HOUSE OR SOMETHING MORE PRECIOUS.”

David, business consultant



# A BETTER WAY TO GET HEALTH INSURANCE.



COVER OREGON™

CoverOregon.com | 1-855-CoverOR



Cover Oregon™ is a new online marketplace where you can compare and enroll in health insurance—and get financial help to pay for it.

### Cover Oregon offers you

- One-stop shopping
- Choice among many plans
- Quality coverage
- Free help from our trained specialists, certified agents and partners

Whether you’re just thinking of getting insurance or want a better option, Cover Oregon can help you find the right plan for you and your family.

Cover Oregon is proudly supported by the:



Visit OHA’s  
Public Health Division  
at [HealthOregon.org](http://HealthOregon.org).

✓ SIGN UP THROUGH COVER OREGON TODAY.